

CP3047-178 R.H AS DRAWN  
CP3047-179 L.H OPPOSITE

THIS IS A 24 VANE DISC  
APPROX DISC WEIGHT = 4.24kg

THIS DISC HAS BEEN DESIGNED TO WORK WITH A  
PAD SWEPT DEPTH OF D46

SUFFIX TO DISC PART NUMBERS:

SUFFIX	DETAILS
P	PLAIN (NO GROOVES)
Gn	STRAIGHT GROOVE - VALUE 'n' SPECIFIES NO. OF GROOVES PER FACE. EG. G4 SPECIFIES 4 GROOVES PER FACE.
CGn	CURVED GROOVE - VALUE 'n' SPECIFIES NO. OF GROOVES PER FACE. EG. CG8 SPECIFIES 8 GROOVES PER FACE.

FOR DISC MOUNTING TECHNIQUES,  
BEDDING PROCEDURE AND DISC  
COOLING RECOMMENDATIONS SEE  
A P RACING BRAKE CALIPER CATALOGUE

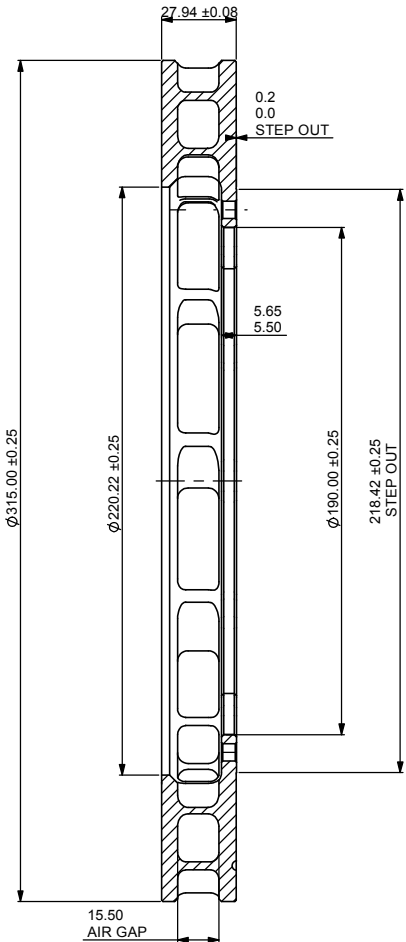

12 HOLES Ø6.45 THRO'  
Ø6.40  
EQUISPACED ON A Ø177.80 PCD

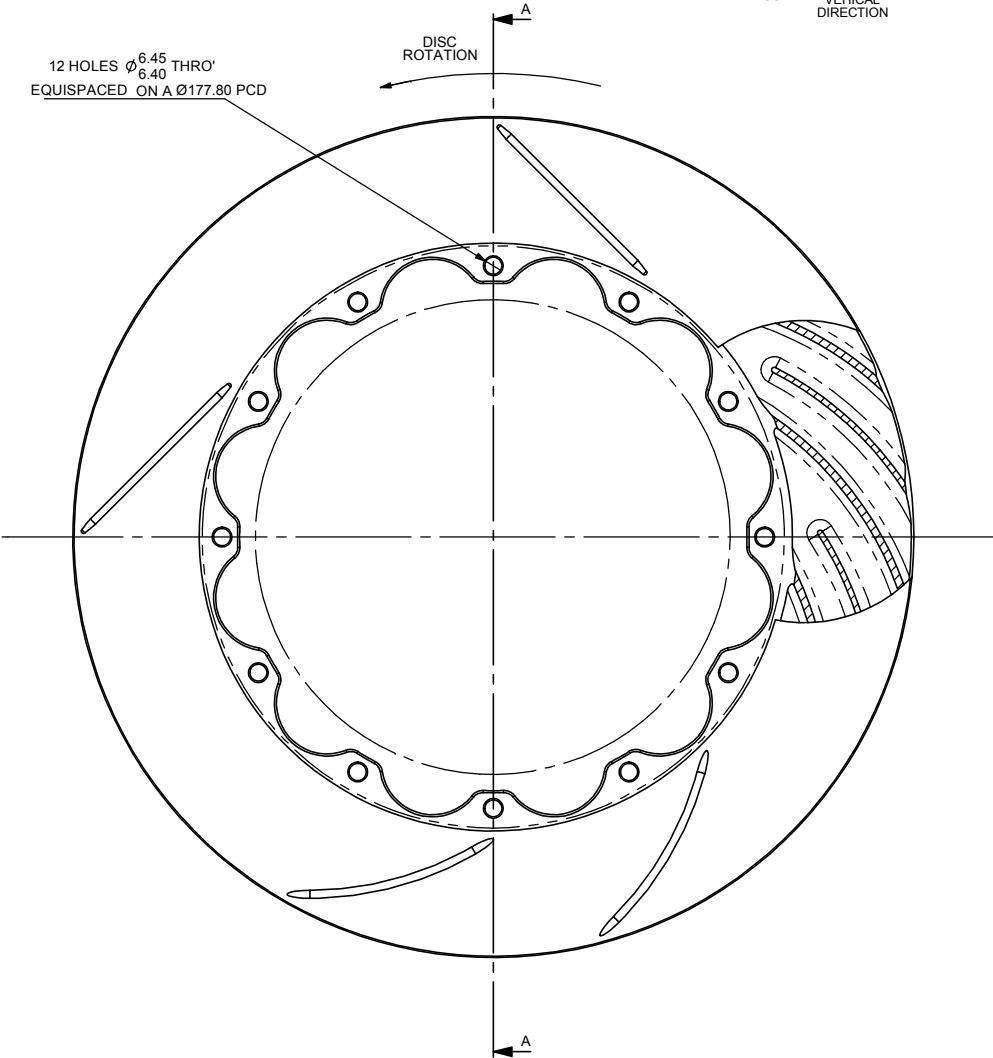

DISC INSTALLATION

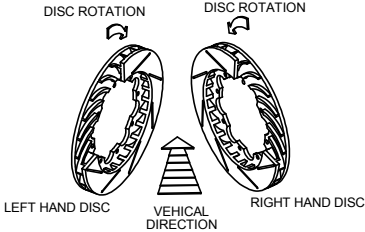

Issue No.	Date & No.	Alterations	Zone	Initials
		Particulars		
40	10/04/06 B4460	UPDATED WITH CURRENT GROOVE TYPES CONVERTED TO TWIN TURN 0.20/0.00 STEP ADDED Ø218.42 ADDED	2K	SAT

SCALE 1:1		SHEET 1 OF 1	
DRAWN	Steve Thomas		
APPROVED			
DERIVED FROM			
TITLE			
Ø315.00 x 27.94			
VENTILATED DISC			
DRG NO.	CP3047-178/179		