

B1

INSTALLATION DRAWING

IF THIS DOCUMENT IS PRINTED IN HARDCOPY,
IT IS FOR INFORMATION USE ONLY AND THEREFORE
IS NOT SUBJECT TO UPDATING CONTROLS. ALWAYS
REFER TO SOLIDWORKS VIEWER FOR LATEST ISSUE



THIS DRAWING IS CONFIDENTIAL AND IS SUPPLIED ON THE EXPRESS CONDITION THAT
IT SHALL NOT BE LOANED OR COPIED OR DISCLOSED TO ANY OTHER PERSON OR USED
FOR ANY OTHER PURPOSE WITHOUT THE WRITTEN CONSENT OF AP RACING LTD.



© AP Racing Ltd. 2004
AP Racing
Wheler Road
Coventry
CV3 4LB

Tel: +44 024 7663 9595
Fax: +44 024 7663 9559

e-mail: sales@aprac racing.co.uk
Web site: HTTP://www.aprac racing.com

Issue No.	Alterations		Zone	Initials
	Date & No.	Particulars		
1	24/05/01 B3036	FIRST ISSUE		JH
2	04/05/05	17Nm MAX BLEED SCREW TIGHTENING TORQUE WAS 25Nm AT AMBIENT & 17Nm FOR BODY > 100°C		JH

GENERAL DESCRIPTION.
A FOUR PISTON, DIFFERENTIAL BORE MONOBLOCK CALIPER DESIGNED TO OPERATE ON A
VENTILATED IRON DISC OF 328.0 DIA. x 35.56 WIDE (12.91" x 1.4") IN A 381.0 (15") DIA. WHEEL.
RADIAL MOUNTS ARE USED TO GIVE POSITION ADJUSTMENT IN 2 PLANES AND TO FACILITATE
PAD CHANGES.
HIGH TEMPERATURE SEALS ARE FITTED IN THE BORE, ALONG WITH STAINLESS STEEL
BRIDGE PIPE AND WEAR PLATES. THE BRIDGE PIPE & BLEED SCREWS HAVE INTEGRAL
PROTECTING RIBS, AND THE CALIPER HAS A SMOOTH RADIAL PROFILE TO AID WHEEL
LOCATION DURING FIT STOPS. THE CALIPER IS COMPATIBLE WITH FLUID RECIRCULATING
SYSTEMS AS STANDARD.
THE CALIPER CAN BE ORDERED WITH A BRACKET TO SUIT STANDARD NASCAR UPRIGHT –
SEE SHEET 2 FOR DETAILS.

TYPICAL APPLICATION – NASCAR WINSTON CUP HEAVY DUTY SHORT TRACK
& ROAD COURSE.

TECHNICAL & INFORMATION
TOTAL PISTON AREA (4): 53.85 cm² [8.35 in²]
PISTON MATERIAL: TITANIUM
BODY MATERIAL: ALUMINIUM ALLOY
BRAKE PADS: CP5850 FAMILY PADS
HYDRAULIC THREADS – 3/8" x 24 UNF .
CALIPER WEIGHT LESS PADS – 3.10kg [6.8lbs]

INSTALLATION INFORMATION
DISC & CALIPER MOUNTING TOLERANCES TO BE SUCH THAT THE DISC IS
CENTRAL TO THE CALIPER TO WITHIN ±0.5mm [0.02in].
DISC DIAMETRICAL CLEARANCE SHOULD BE 2.5mm [0.098in] NOM FROM DISC
O.D. TO PATHWAY. THE O.D. CLEARANCE CAN BE REDUCED TO 1.8mm [0.07in]
MIN FOR SMALL DIA DISCS (280.0mm [11.02in] & LOWER).
BLEED SCREW MAX TIGHTENING TORQUE 17Nm

KEY TO DIMENSIONS
DIMENSION 'PL': TOP OF PAD MATERIAL TO MOUNTING BOSS FACE WITH PAD
SITTING DOWN ON LEDGE.
DIMENSION 'U': WHEEL CENTRE LINE TO CALIPER MOUNTING BOSS FACE (DISC
Ø/2) – DIMENSION 'PL'
DIMENSION 'C': OFFSET-DISC CENTRE LINE TO MOUNTING HOLES.
EFFECTIVE RAD: DISTANCE FROM WHEEL CENTRELINE TO NOMINAL PISTON
CENTRE LINE.

AP RACING TECHNICAL SECTION WILL BE PLEASED TO ADVISE ON THE MOST SUITABLE
EQUIPMENT FOR ANY PARTICULAR APPLICATION

CALIPER PART NUMBERS	
ASSEMBLY NO.	CALIPER HANDING
CP5850-2S0M	RIGHT HAND TRAILING
CP5850-3S0M	LEFT HAND TRAILING
CP5850-4S0M	RIGHT HAND LEADING
CP5850-5S0M	LEFT HAND LEADING

CALIPER & BRACKET ASSEMBLY NO.	CALIPER HANDING
CP5850-2S0M-NASCAR	RIGHT HAND TRAILING
CP5850-3S0M-NASCAR	LEFT HAND TRAILING
CP5850-4S0M-NASCAR	RIGHT HAND LEADING
CP5850-5S0M-NASCAR	LEFT HAND LEADING

SEAL KIT PART NO.	
CP4518-JL	

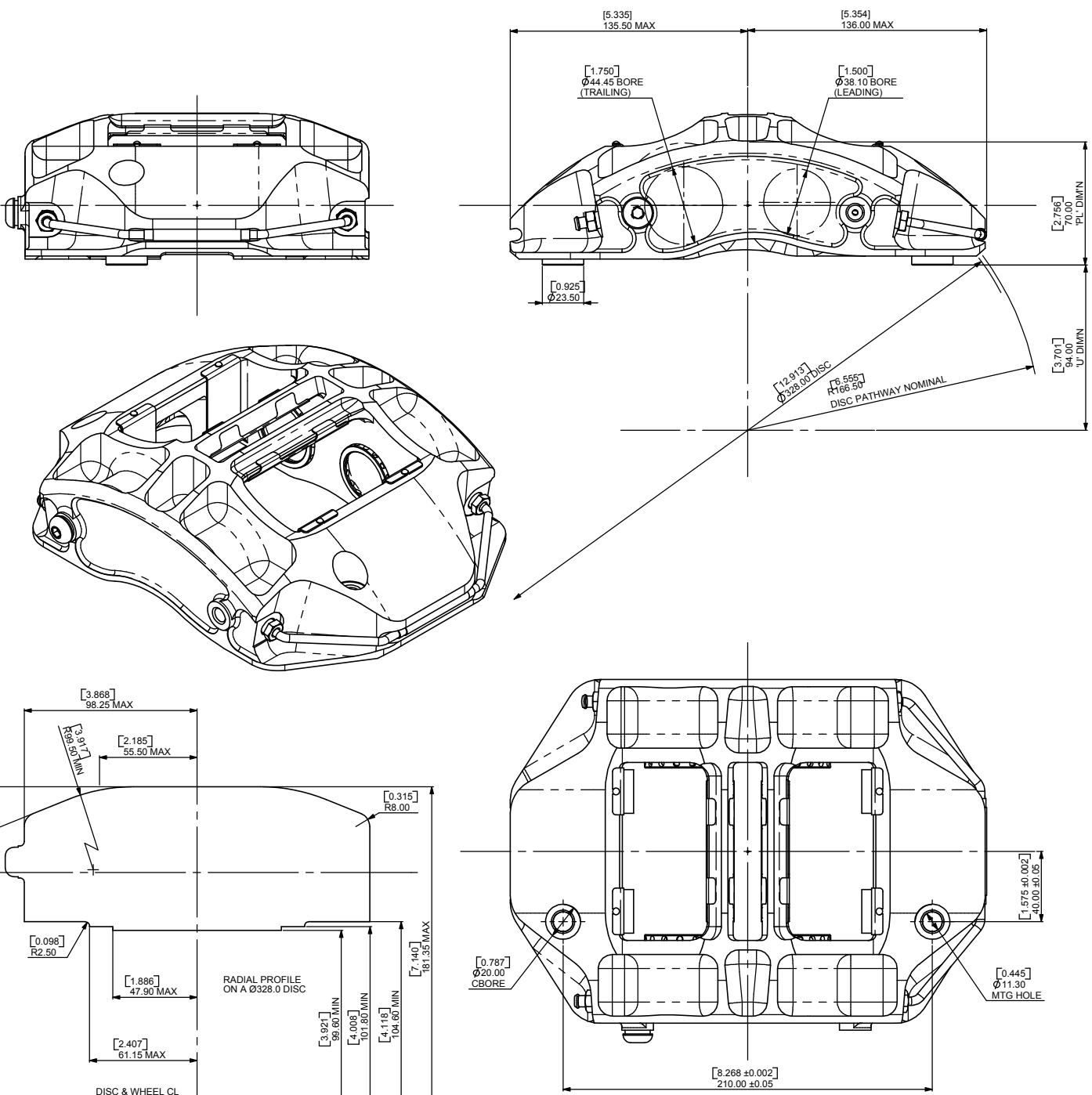

SCALE 1:1		SHEET 1 OF 2	
DRAWN	Peritage		
APPROVED			
DERIVED FROM			
TITLE			
4 PISTON MONOBLOCK CALIPER INSTALLATION			
DRG NO.	cp5850-1cd		



Issue No.	Alterations		Zone	Initials
	Date & No.	Particulars		
		SEE SHEET 1 FOR CURRENT ISSUE.		

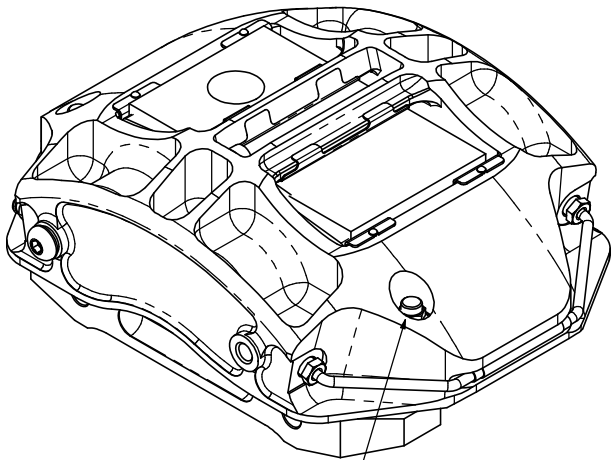
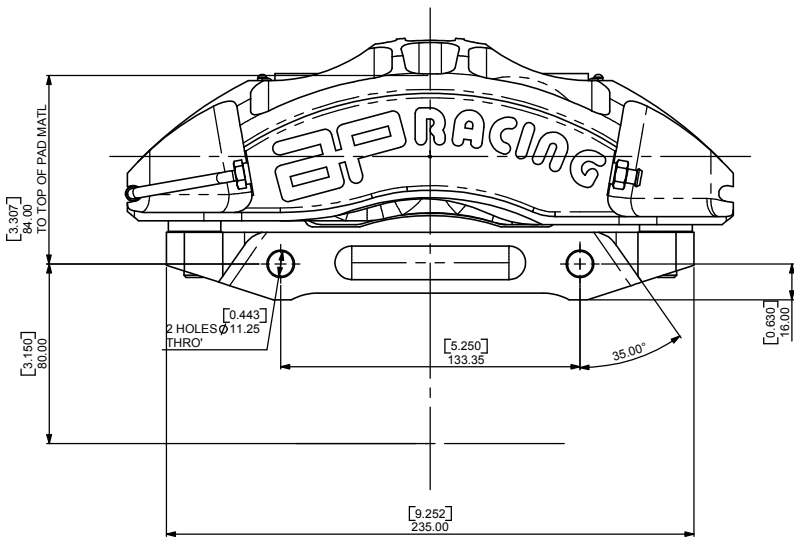
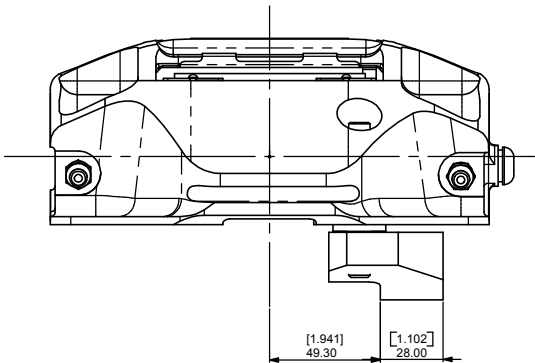

3/8" UNF KAYLOCK
TIGHTENING TORQUE
41Nm [50Lbs ft]

ISOMETRIC VIEWS

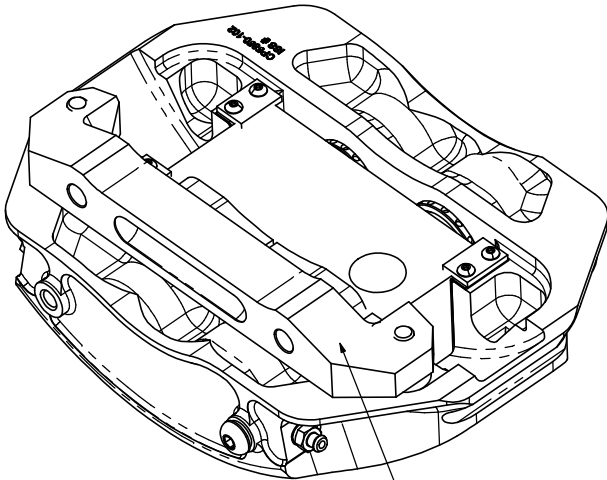

BRACKET ASSEMBLY - CP5820-7
(BRACKET, STUDS, NUTS AND WASHERS)

SCALE 1:1		SHEET 2 OF 2	
DRAWN	Peritarge		
APPROVED			
DERIVED FROM			
TITLE			
4 PISTON MONOBLOCK CALIPER INSTALLATION			
DRG NO.	cp5850-1cd		