

Engine: Removal and Replacement

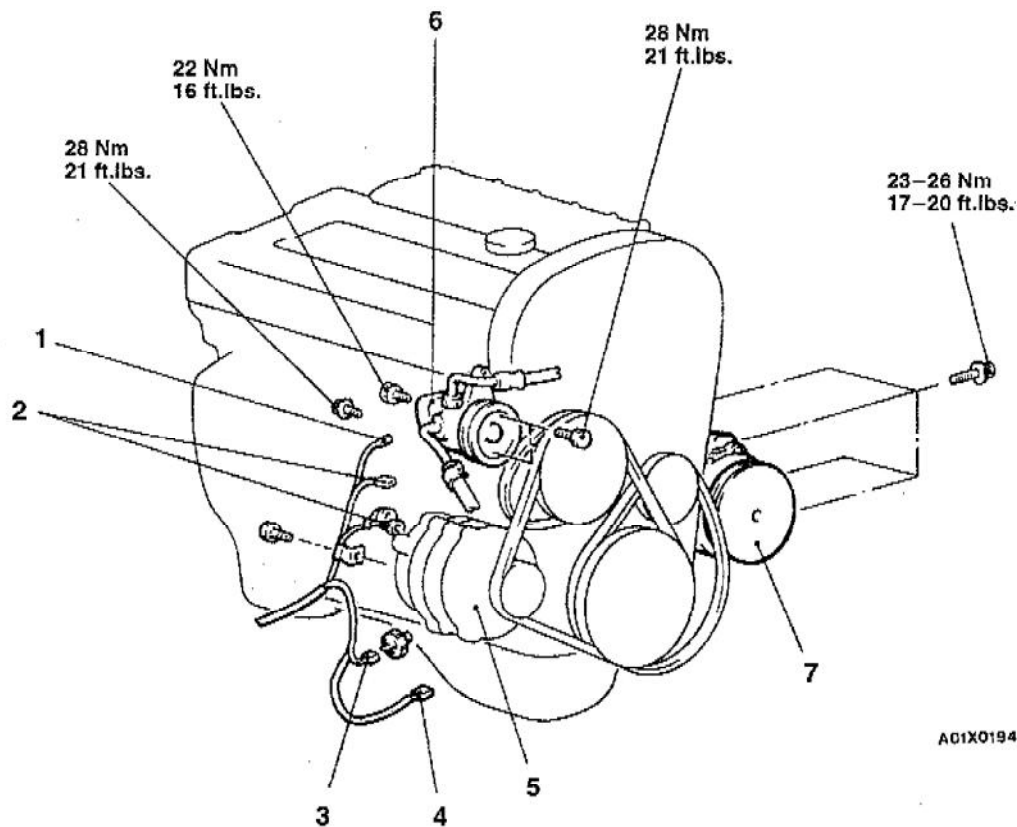

Removal steps

1. Power steering pressure switch connector
2. Generator connectors
3. Oil pressure switch connector
4. Oil pressure gauge unit connector
5. Generator
6. Power steering pump connection
7. A/C compressor connection

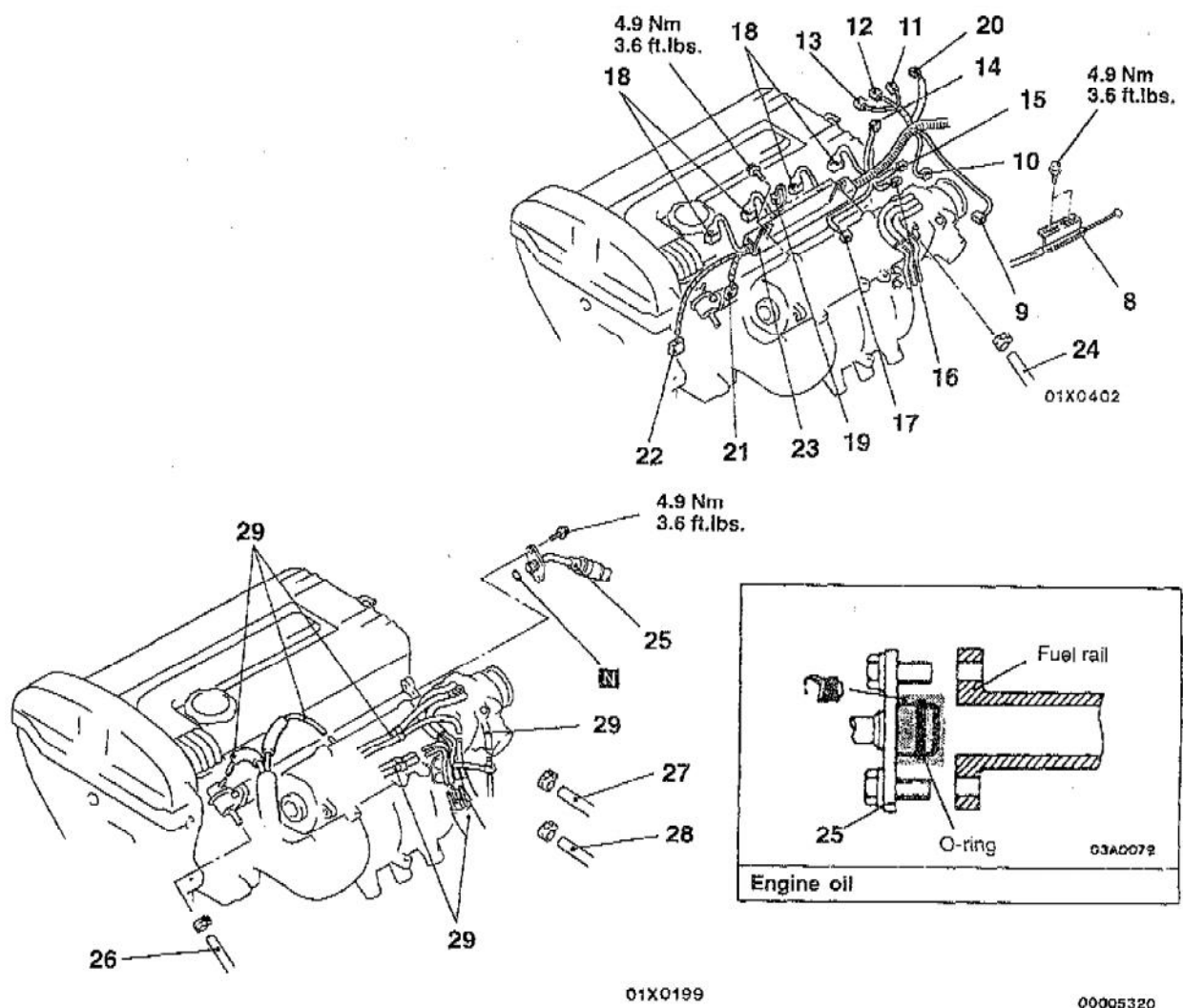

- 8. Accelerator cable connection
- 9. Idle air control motor connector
- 10. Knock sensor connector
- 11. Heated oxygen sensor connector
- 12. Engine coolant temperature gauge unit connector
- 13. Engine coolant temperature sensor connector
- 14. Ignition power transistor connector
- 15. Throttle position sensor connector
- 16. Capacitor connector
- 17. Manifold differential pressure sensor connector
- 18. Injector connectors

- 19. Ignition coil connector
- 20. Camshaft position sensor connector
- 21. Crankshaft position sensor connector
- 22. Air conditioning compressor connector
- 23. Control wiring harness
- 24. Brake booster vacuum hose connection
- 25. High-pressure fuel hose connection
- 26. Fuel return hose connection
- 27. Water hose A connection
- 28. Water hose B connection
- 29. Vacuum hoses connection

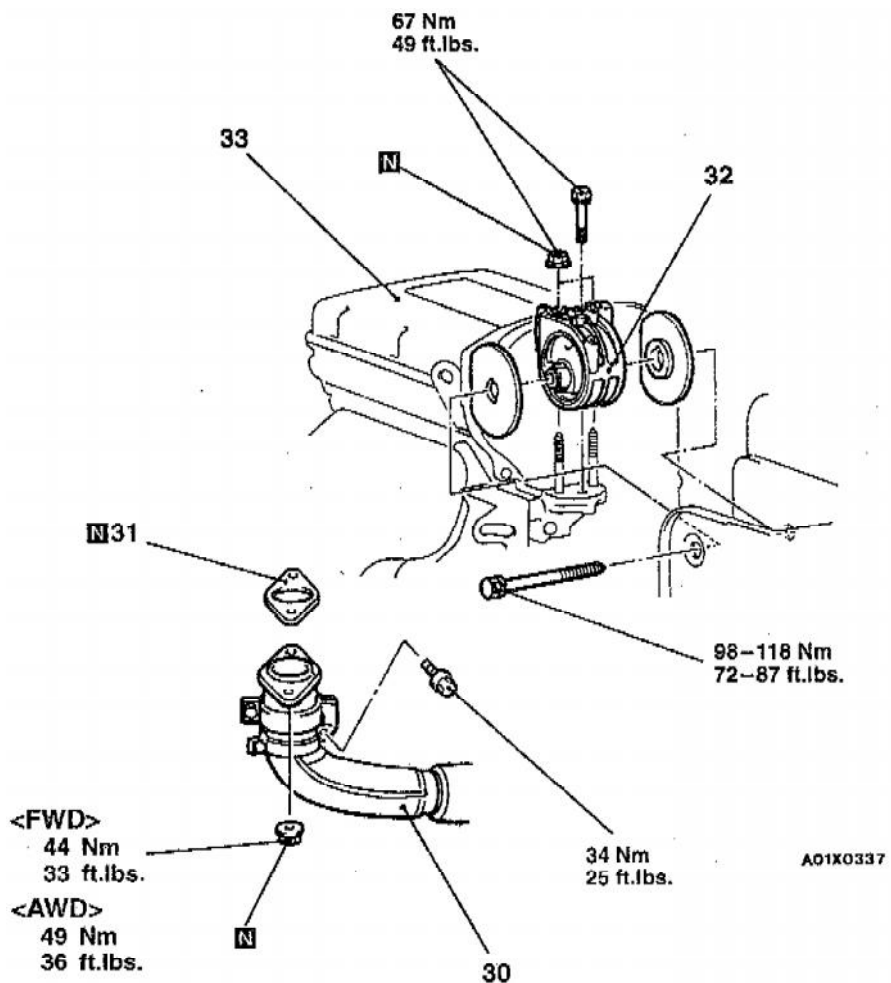

- 30. Front exhaust pipe connection
- 31. Gasket
- 32. Engine mount bracket
- 33. Engine assembly

REMOVAL

1. Release fuel line pressure.
2. Remove hood. Refer to Body and Frame.
3. Drain Cooling System.
4. Remove transaxle assembly. Refer to Transmission and Drivetrain.
5. Remove radiator. Refer to Cooling System.
6. Remove under cover. Refer to Body and Frame.
7. Follow removal procedure outlined in illustration.
8. Remove the power steering pump from the bracket with the hose attached.

NOTE: Place the removed power steering pump in a place where it will not be a hindrance when removing and installing the engine assembly, and tie it with a cord.

9. Disconnect the A/C compressor connector and remove the compressor from the compressor bracket with the hose still attached.

CAUTION: Do not bend the joint between the A/C hose and the A/C pipe by force.

NOTE: Place the removed A/C compressor in a place where it will not be a hindrance when removing and installing the engine assembly, and tie it with a cord.

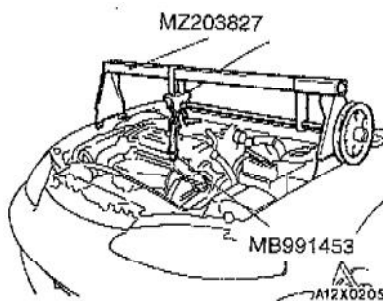

10. Support the engine with a garage jack.
11. Remove the special tool which was attached when the transaxle assembly was removed.
12. Hold the engine assembly with a chain block or similar tool.
13. Place a garage jack against the engine oil pan with a piece of wood in between, jack up the engine so that the weight of the engine is no longer being applied to the engine mount bracket, and then remove the engine mount bracket.
14. After checking that all cables, hoses and harness connectors, etc., are disconnected from the engine, lift the chain block slowly to remove the engine assembly upward from the engine compartment.

INSTALLATION

1. Follow removal procedure in reverse order, noting the following.
2. Install the engine assembly while checking that the cables, hoses, and harness connectors are not clamped.
3. Place a garage jack against the engine oil pan with a piece of wood in between, and install the engine mount bracket while adjusting the position of the engine.
4. Support the engine with the garage jack.
5. Remove the chain block and support the engine assembly.

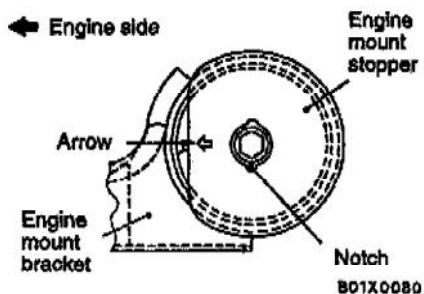

6. Align the notches on the stopper with the engine mount bracket with the arrow mark facing toward the shown direction. Then install the stopper.
7. When connecting the high-pressure fuel hose to the fuel rail, apply a small amount of clean engine oil to the hose union and then insert, being careful not to damage the O-ring.

CAUTION: Do not let engine oil get into the fuel rail.

8. Fill Cooling System.
9. Perform accelerator cable adjustment. Refer to Powertrain Management.
10. Perform drive belt tension adjustment.