

Dashboard / Instrument Panel: Service and Repair

1. Disconnect battery ground cable.
2. Remove steering wheel as outlined in "Electrical" section of "Eclipse" chassis section.
3. Remove center console assembly as follows:

NOTE
↔ : Metal clip position

Removal steps

1. Center console panel
2. Ashtray and cupholder assembly
3. Ashtray
4. Cup holder
5. Shift lever knob <M/T>
6. Floor console assembly
7. Ashtray illumination light bracket

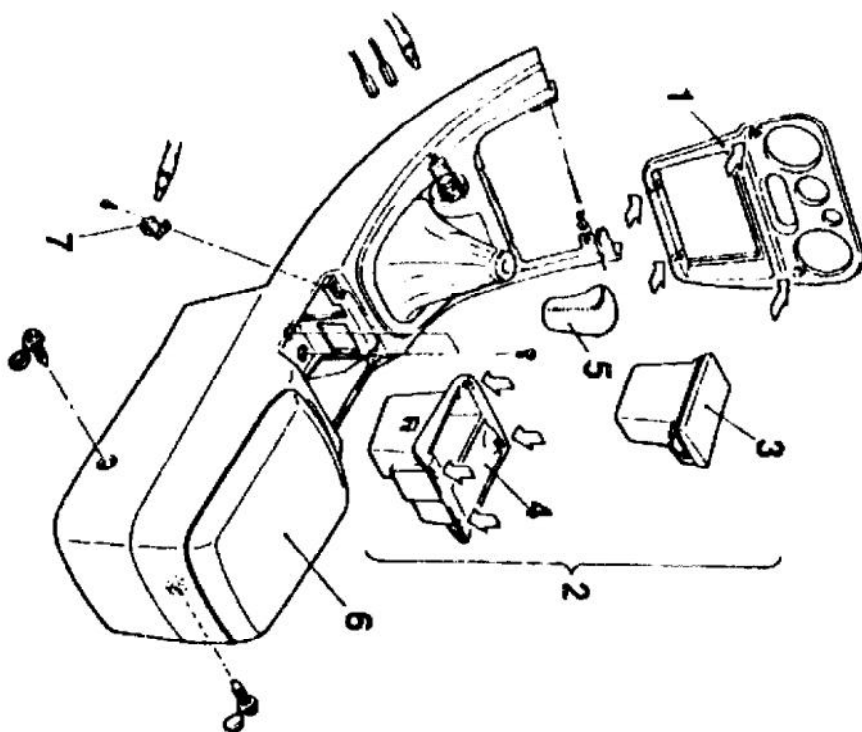

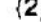
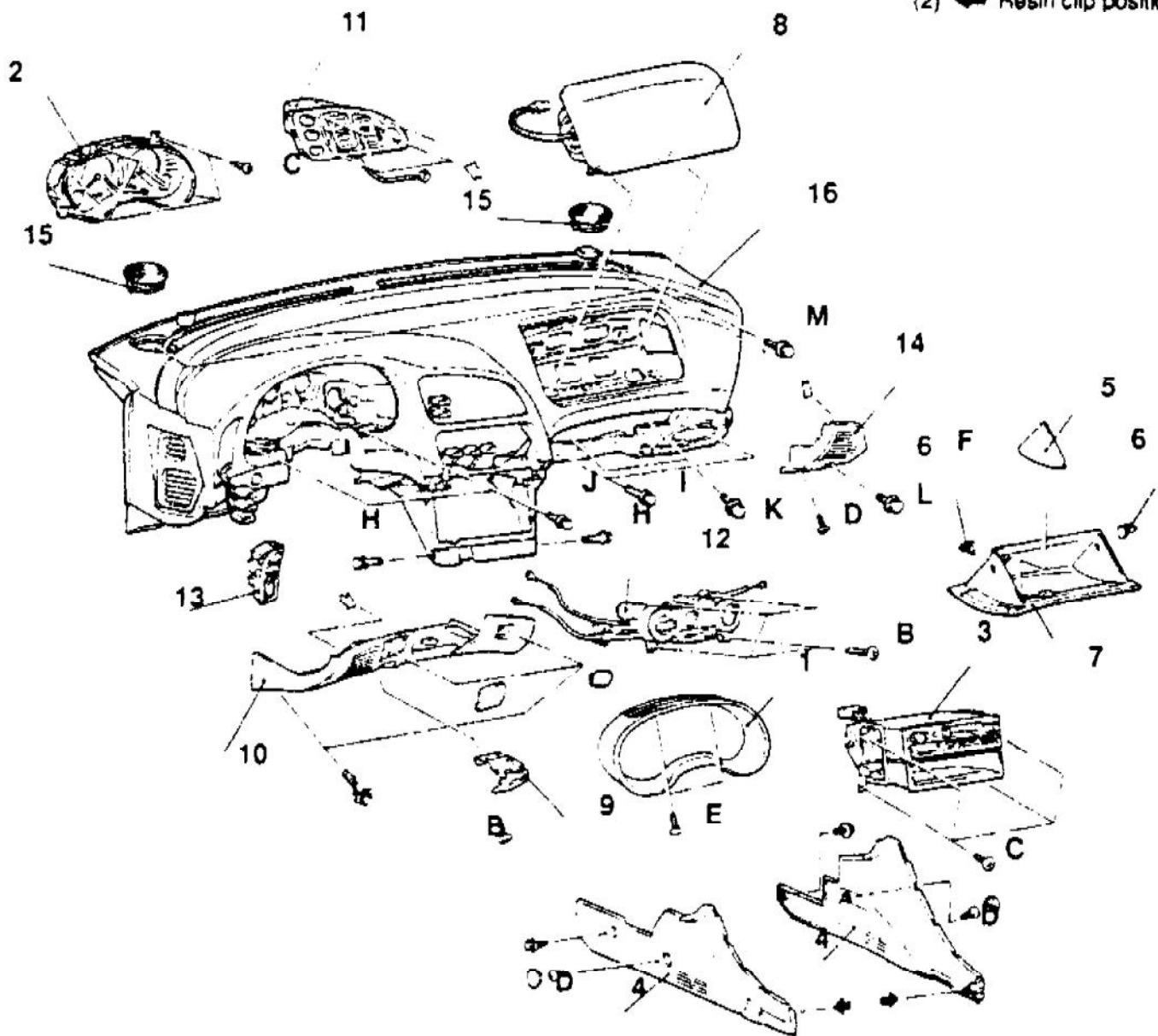

Fig. 14 Exploded View Of Center Console Assembly

- a. Remove center console panel, Fig. 14.
- b. Remove ashtray and cup holder assembly.
- c. **On models with manual transaxle**, remove shift knob.
- d. Remove center console assembly.

NOTE

- (1)  Metal clip position
 (2)  Resin clip position

**Removal steps**

- | | |
|---|---------------------------------|
| 1. Meter bezel | 9. Hood lock release handle |
| 2. Combination meter | 10. Instrument under cover L.H. |
| 3. Radio and tape player, and box | 11. Center air outlet assembly |
| 4. Console side cover | 12. Heater control assembly |
| 5. Sunglasses holder | 13. Instrument panel switch |
| 6. Stopper | 14. Instrument under cover R.H. |
| 7. Glove box | 15. Front speaker |
| 8. Passenger's side air bag module assembly | 16. Instrument panel assembly |

Fig. 15 Exploded View Of Instrument Panel

4. Remove combination meter bezel, then the combination meter, **Fig. 15**.
5. Remove radio and tape player.
6. Remove console side cover and sunglasses holder.
7. Remove glove box and passenger air bag assembly.
8. Remove hood lock release handle, then the left-hand side instrument under cover.

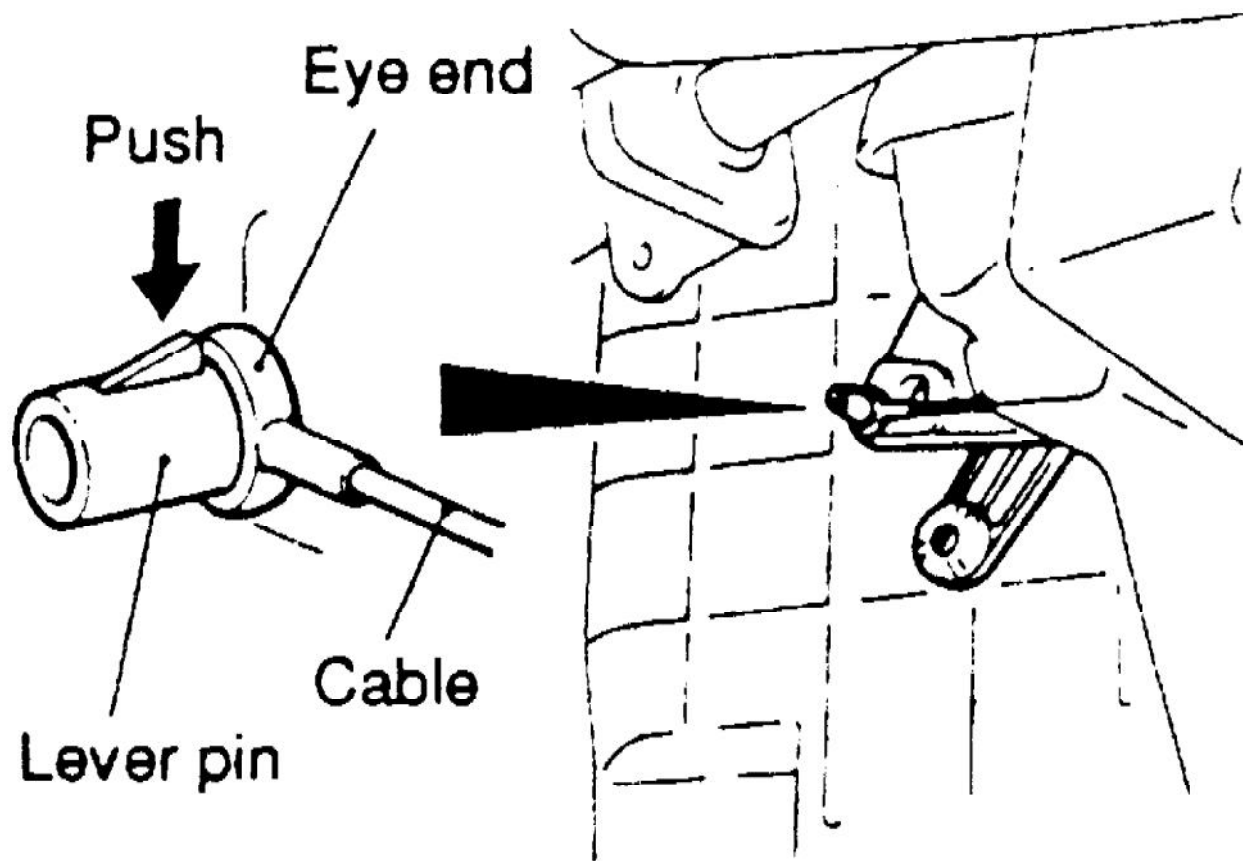

Fig. 16 Air Outlet Changeover Damper Cable

9. Remove center outlet assembly by pushing lever pin to disconnect air outlet changeover damper cable, **Fig. 16**.
10. Remove heater control assembly.
11. Remove instrument panel switch and right-hand instrument under cover.
12. Remove speakers from top of instrument panel.
13. Remove instrument panel from vehicle.
14. Reverse procedure to install, noting the following:
 - a. Set temperature control knob on heater control assembly to "MAX HOT" position.

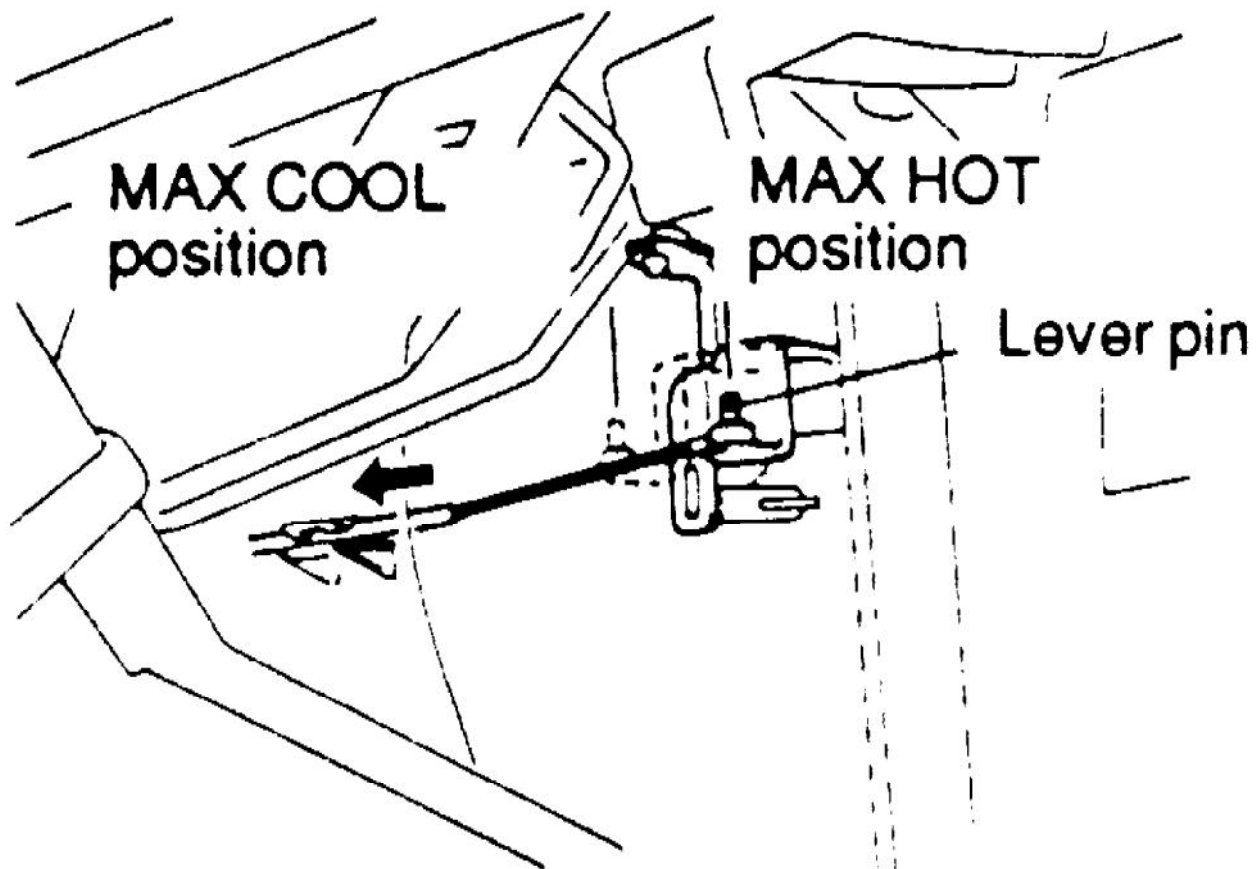

Fig. 17 Heater Control Unit Installation

- b. Set air mix damper lever at top of heater unit to "MAX HOT" position, then install cable to lever pin, **Fig. 17**.
- c. Push outer cable in direction of arrow as shown in **Fig. 17**, ensure there is no looseness in cable, then secure it with clip.
- d. Set knob for air outlet changeover on heater control assembly to the "DEF" position.
- e. Set air outlet changeover damper lever of heater unit to the "DEF" position, then install cable to lever pin, **Fig. 16**.